

HAZVAC

**INDUSTRIAL VACUUM CLEANER WITH HEPA FILTER
FOR WET AND DRY RECOVERY**

INSTRUCTION MANUAL FOR MODEL EC-12(G) HEPA

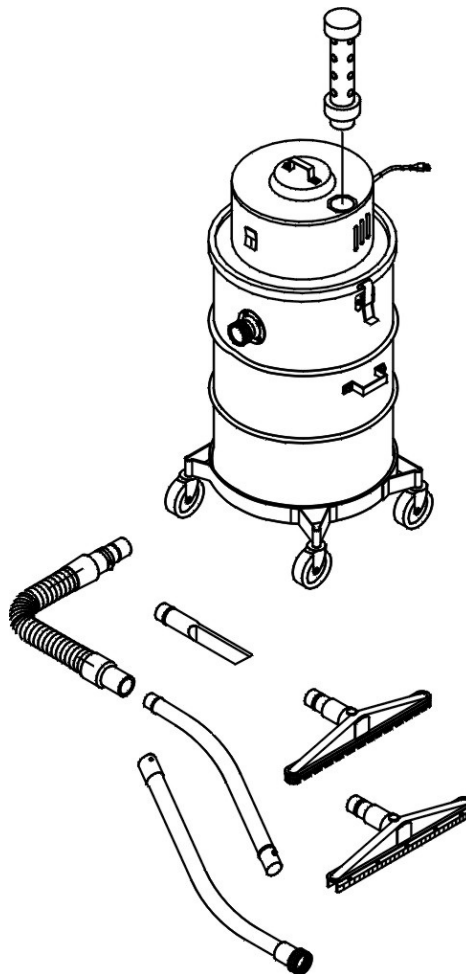

**TO ENSURE A SAFE WORKING ENVIRONMENT,
CAREFULLY READ AND FOLLOW ALL INSTRUCTIONS**

SAVE THESE INSTRUCTIONS



TABLE OF CONTENTS

	PAGE	
1.	INSPECTION	1
2.	IMPORTANT HEALTH AND SAFETY PRECAUTIONS	1
3.	IMPORTANT SAFETY PRECAUTIONS	1
4.	GROUNDING INSTRUCTIONS	2
5.	OPERATING INSTRUCTIONS FOR DRY RECOVERY	3
6.	OPERATING INSTRUCTIONS FOR LIQUID RECOVERY	4
7.	INSTALLING AND REPLACING HEPA FILTER	5

1. INSPECTION

Carefully unpack and inspect your Hazvac. Each vacuum cleaner is tested and thoroughly inspected before being shipped; therefore, any damage is the responsibility of the delivering carrier, who should be notified. Read all instructions carefully before operating vacuum cleaner.

2. IMPORTANT HEALTH AND SAFETY PRECAUTIONS

WARNING: If this vacuum cleaner is used to recover toxic or nuisance substances such as: asbestos, lead, silica, pesticides, etc., the following safety precautions must be taken.

- a. Vacuum cleaner must be equipped with an HEPA filter.
- b. Service and operation should only be carried out by trained personnel wearing appropriate clothing and breathing apparatus.
- c. Dispose of collected materials responsibly. Follow government Regulations for the disposal of hazardous materials.

NOTE: Any health hazard associated with the use of this vacuum cleaner in conjunction with the recovery of asbestos and other hazardous substances has not been investigated by CSA (Canadian Standards Association).

3. IMPORTANT SAFETY INSTRUCTIONS

READ ALL INSTRUCTIONS BEFORE OPERATING VACUUM CLEANER

WARNING: To reduce the risk of fire, electrical shock, or Injury:

- a. Do not leave vacuum cleaner when plugged in. Unplug from outlet when not in use and before servicing.
- b. Do not allow vacuum cleaner to be used by children. Close attention is necessary when used near children.
- c. Use only as described in this manual.
- d. Use only with recommended attachments.
- e. Do not use with damaged cord or plug.
- f. If vacuum cleaner is not working as it should, has been dropped, damaged, left outdoors, or dropped into water, return it to a service centre.
- g. Do not: pull or carry by cord, use cord as a handle, close a door on cord, or pull cord around sharp edges or corners.

- h. Do not run vacuum cleaner over cord.
- i. Keep cord away from heated surfaces.
- j. Do not unplug by pulling on cord. To unplug, grasp the plug, not the cord.
- k. Do not handle plug or appliance with wet hands.
- l. Do not put any object into openings.
- m. Do not use with any openings blocked; keep free of dust, lint, hair and anything that may reduce air flow. Poor ventilation will result in overheating of motor.
- n. Keep hair, loose clothing, fingers and all parts of body away from openings and moving parts.
- o. Do not pick-up anything that is burning or smoking such as: cigarettes, matches or hot ashes., etc.
- p. Do not use without appropriate filters in place.
- q. Turn of all controls before unplugging.
- r. Use extra care when cleaning on stairs.
- s. Do not recover flammable or combustible liquids such as gasoline, or use in areas where they may be present.
- t. Never operate unit unless the power-head is securely fastened to the recovery tank with latches.
- u. Connect to a properly grounded outlet only. See grounding instructions.

4. GROUNDING INSTRUCTIONS

This vacuum cleaner must be grounded. If it should malfunction or breakdown, grounding provides a path of least resistance for electric current to reduce the risk of electric shock. This vacuum cleaner is equipped with a cord having an equipment-grounding conductor and grounding plug. The plug must be plugged into an appropriate outlet that is properly installed and grounded in accordance with all local codes and ordinances.

WARNING: Improper connection of the equipment-grounding conductor can result in a risk of electric shock. Check with a qualified electrician or service person if you are in doubt as to whether an outlet is properly grounded. Do not modify the plug provided with the vacuum cleaner. If it will not fit the outlet, have a proper outlet installed by a qualified electrician. No adaptor should be used with this vacuum cleaner.

5. OPERATING INSTRUCTIONS FOR DRY RECOVERY

- A. Suction intake
 - B. Floater
 - C. Exhaust silencer / working air exhaust
 - D. Cooling air intake
 - E. Cooling air exhaust
-
- 1. Paper filter bag
 - 2. Polyester filter with clamp
 - 3. HEPA filter

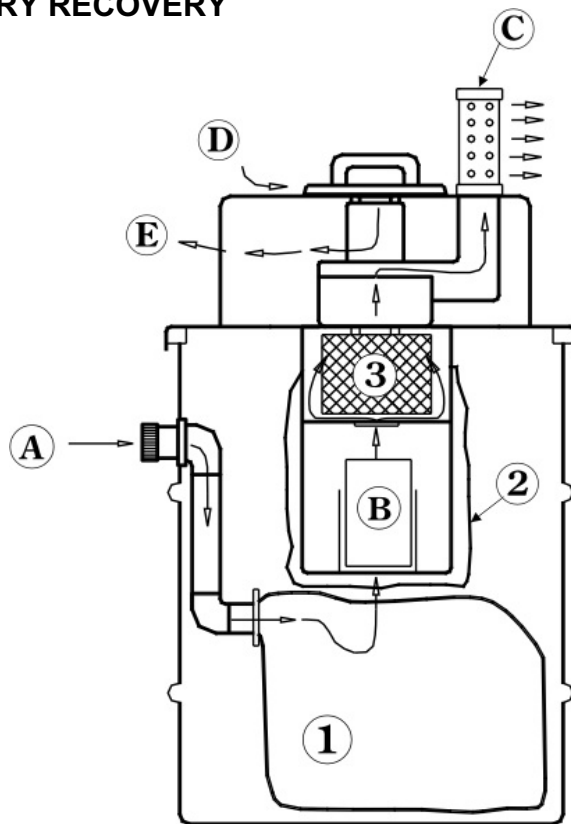

DRY

- a) Release latches and remove power-head from recovery tank.
- WARNING:** Make sure that the HEPA FILTER is properly installed prior to use.
- b) Install pvc pipe connector to the suction intake and install the paper filter bag on the pvc pipe connector. Make sure that the rubber collar of the paper filter bag fits snugly around the pvc pipe connector.
 - c) Install the polyester filter over the HEPA housing and floater cage. Tighten clamp to secure filter in place. Ensure that polyester filter is completely dry before installing.
 - d) Place power-head on recovery tank and fasten latches.
 - e) Fasten hose to suction intake on side of recovery tank and attach desired tools to hose.
 - f) Operate on grounded electrical outlets only (see grounding instructions).

6. OPERATING INSTRUCTIONS FOR LIQUID RECOVERY

- A. Suction intake
 - B. Floater
 - C. Exhaust silencer / working air exhaust
 - D. Cooling air intake
 - E. Cooling air exhaust
-
- 2. Polyester filter with clamp
 - 3. HEPA filter

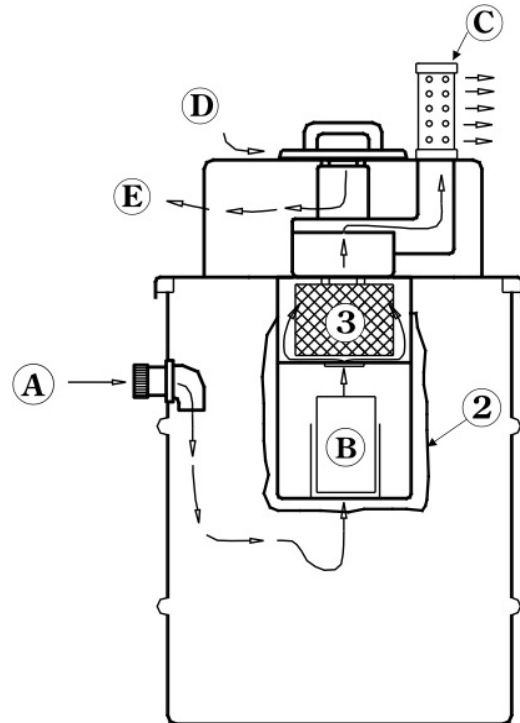

WET

- a. Release latches and remove power-head from recovery tank.
- b. Remove pvc pipe connector and remove paper filter bag.
- c. Clean out inside of recovery tank.
- d. It is recommended that the polyester filter remain in place during liquid recovery if the liquid to be recovered contains dirt and debris. The polyester filter must be completely dry before it can be used for dry recovery. The polyester filter maybe removed for liquid recovery if the liquid to be recovered is clean.
- e. Place power-head on recovery tank and fasten latches.
- f. Fasten hose to suction intake on the side of recovery tank and attach desired tools.
- g. Operate on grounded electrical outlets only (see grounding instructions). After wet recovery, empty and dry the inside of recovery tank.

WARNING: Do not completely submerge the recovery hose in the fluid. This may cause the recovery tank to overflow due to siphoning action. Hold recovery hose at surface of liquid to allow a mixture of fluid and air to enter the recovery hose. This vacuum cleaner is not intended for use as a transfer pump.

7. INSTALLING AND REPLACING HEPA FILTER

- a. Unscrew the three hex nuts which hold the HEPA housing to the lid.
- b. Remove contaminated filter and
- c. Install a new filter of the same configuration.
- d. Tightly fasten HEPA housing to lid with three hex nuts.
- e. Make sure that all protective gaskets form a perfect seal in and around the HEPA housing.
- f. Follow all applicable regulations for the disposal of used filter,